



# The Generational Homeowner's Guide

---

**Building and Maintaining Your Maine Legacy Home**

Presented by Generations Custom Homes

# Table of Contents

1. Introduction: The Generational Home Concept
2. Understanding Maine's Environment
3. Foundation & Structural Integrity
4. Exterior Envelope: Siding, Roofing, & Windows
5. Insulation & Energy Efficiency
6. Interior Durability & Finish Work
7. Seasonal Maintenance Schedules
8. Landscaping & Site Drainage
9. Emergency Preparedness & Safety
10. Long-Term Value & Upgrades
11. Working with Generations Custom Homes
12. Appendix & Resources

# 1. Introduction: The Generational Home Concept

A **generational home** is more than just a house—it's a legacy built to last through Maine's toughest seasons and designed to be passed down through your family for decades. At Generations Custom Homes, we believe in building homes that combine exceptional craftsmanship, climate-resilient materials, and timeless design.

## What Makes a Home "Generational"?

- **Superior Craftsmanship:** Every detail, from foundation to finish, is built by skilled professionals who understand Maine's unique challenges.
- **Climate-Resilient Materials:** We use only the best materials designed to withstand harsh winters, coastal salt air, and seasonal temperature swings.
- **Future-Proof Design:** Flexible layouts, modern systems, and smart technology integration ensure your home remains functional and valuable for generations.
- **Low Maintenance, High Durability:** Generational homes require minimal major repairs, thanks to expert construction and quality materials.

## Why This Guide?

Whether you're planning to build a custom home in Maine or maintain an existing property, this comprehensive guide provides professional insights, pro tips from experienced builders, and region-specific advice for coastal and inland Maine homes.

**Ready to start your generational home journey? Contact Generations Custom Homes today for a personalized consultation at [generationscustomhomes.com](https://generationscustomhomes.com).**

## 2. Understanding Maine's Environment

Maine's diverse climate presents unique challenges depending on your location. Understanding these regional differences is essential for building and maintaining a generational home.

### Coastal Maine

#### Challenges:

- **Salt Air Corrosion:** Ocean spray accelerates wear on metal fixtures, siding, and roofing.
- **High Winds & Storm Surge:** Hurricanes and nor'easters demand robust structural engineering.
- **Moisture & Humidity:** Persistent humidity can lead to mold and rot if not properly managed.

***Pro Tip:** Use corrosion-resistant materials like stainless steel fasteners, galvanized flashing, and fiber cement or cedar siding treated with marine-grade sealants.*

### Inland Maine

#### Challenges:

- **Deep Frost Lines:** Foundations must extend below frost depth (typically 4+ feet) to prevent heaving.
- **Heavy Snow Loads:** Roofs need to be engineered for significant snow accumulation.
- **Wide Temperature Swings:** Extreme cold in winter and warm summers require superior insulation.

***Pro Tip:** Install standing seam metal roofs to shed snow efficiently and prevent ice dams.*

### Seasonal Weather Patterns

**Winter (Dec–Mar):** Sub-zero temperatures, heavy snow, ice storms

**Spring (Apr–May):** Freeze-thaw cycles, flooding risk, mud season

**Summer (Jun–Aug):** Warm, humid conditions; occasional severe thunderstorms

**Fall (Sep–Nov):** Rapid cooling, early frost, hurricane season (coastal)

### 3. Foundation & Structural Integrity

The foundation is the literal and figurative bedrock of a generational home. Maine's freeze-thaw cycles and varied soil conditions demand expert foundation work.

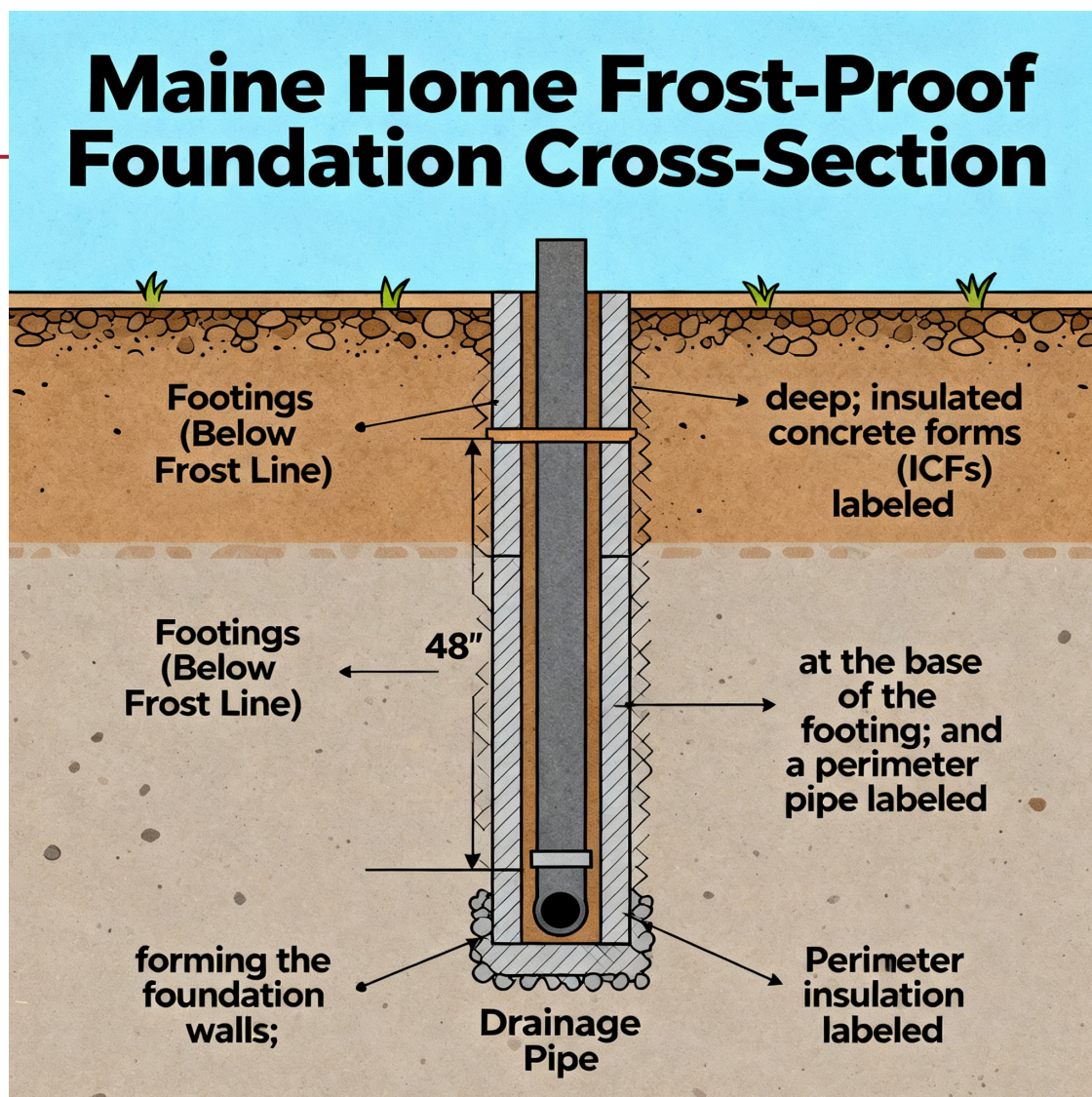

Figure: Frost-proof foundation cross-section for Maine homes.

#### **Pro Tip: Frost-Proof Foundations**

##### **What Professional Builders Do:**

- *Pour foundations below the frost line (minimum 4 feet in most of Maine, deeper in northern regions).*
- *Use insulated concrete forms (ICFs) for superior thermal protection.*
- *Install perimeter drainage systems (French drains) to divert water away from the foundation.*

## For Coastal Homes:

- Elevate foundations above anticipated flood levels.
- Use reinforced concrete and corrosion-resistant rebar.
- Anchor homes securely to resist wind uplift.

## For Inland Homes:

- Ensure proper compaction of fill and backfill materials.
- Install foundation insulation to reduce heat loss.
- Monitor for settling in areas with ledge or clay soils.

## Structural Framing Best Practices

- **Use Engineered Lumber:** LVL (laminated veneer lumber) and engineered joists resist warping and provide consistent strength.
- **Advanced Framing Techniques:** Optimize insulation cavities while maintaining structural integrity.
- **Hurricane Straps & Ties:** Essential for coastal homes; recommended for all Maine builds.

**Call to Action: Need a foundation inspection or consultation? Generations Custom Homes offers expert assessments. Contact us today.**

# 4. Exterior Envelope: Siding, Roofing, & Windows

Your home's exterior envelope is the first line of defense against Maine's weather. Choosing the right materials and installation methods is critical.

## Siding Options for Maine Homes

### 1. Fiber Cement Siding

**Best for:** Coastal and inland homes seeking durability and low maintenance.

**Pros:**

- Fire, insect, and rot-resistant
- Withstands salt air and extreme temperatures
- 50+ year lifespan with minimal maintenance

**Cons:**

- Heavier than vinyl; requires professional installation
- Needs repainting every 10–15 years

**Pro Tip:** Use fiber cement with integrated water management systems and premium paint finishes rated for marine environments.

### 2. Cedar Shingles & Siding

**Best for:** Traditional coastal Maine aesthetics.

**Pros:**

- Naturally resistant to insects and decay
- Beautiful aging patina (silver-gray)
- Excellent insulation properties

**Cons:**

- Higher cost
- Requires regular sealing/staining (every 3–5 years)

***Pro Tip:** Treat cedar with penetrating oil-based stains and marine-grade sealants for maximum longevity.*

### 3. Vinyl Siding

**Best for:** Budget-conscious inland homeowners.

**Pros:**

- Affordable
- Low maintenance
- Wide variety of colors and styles

**Cons:**

- Can crack in extreme cold
- Fades over time from UV exposure
- Less durable than fiber cement or cedar

***Pro Tip:** Choose insulated vinyl and install with proper ventilation to prevent moisture buildup.*

### 4. Metal Siding (Steel/Aluminum)

**Best for:** Modern designs and high-wind coastal areas.

**Pros:**

- Extremely durable and fire-resistant
- Low maintenance
- Reflects heat in summer

**Cons:**

- Can dent from hail or debris
- Higher upfront cost

***Pro Tip:** Use standing seam metal siding with concealed fasteners for a sleek look and superior weather resistance.*

## Roofing for Maine

**Asphalt Shingles:**

- Most common; 20–30 year lifespan
- Choose architectural shingles rated for high winds

**Standing Seam Metal Roofs:**

- 50+ year lifespan
- Sheds snow and ice efficiently
- Ideal for steep pitches and modern designs

**Slate/Synthetic Slate:**

- 75–100+ year lifespan
- Elegant, traditional look
- Expensive but generational quality

***Pro Tip:** Install ice and water shield underlayment on all roof edges and valleys to prevent ice dam leaks.*

## **Windows & Doors**

### **Energy-Efficient Windows:**

- Triple-pane, low-E glass for inland homes
- Impact-resistant, argon-filled for coastal homes

***Pro Tip:** Properly flash and seal all windows and doors with self-adhering membranes and quality caulking to prevent air and water infiltration.*

**Call to Action: Generations Custom Homes specializes in selecting and installing the perfect exterior materials for your Maine location. Schedule a consultation.**

# 5. Insulation & Energy Efficiency

Maine's cold winters demand superior insulation and airtight construction to keep heating costs manageable and homes comfortable.

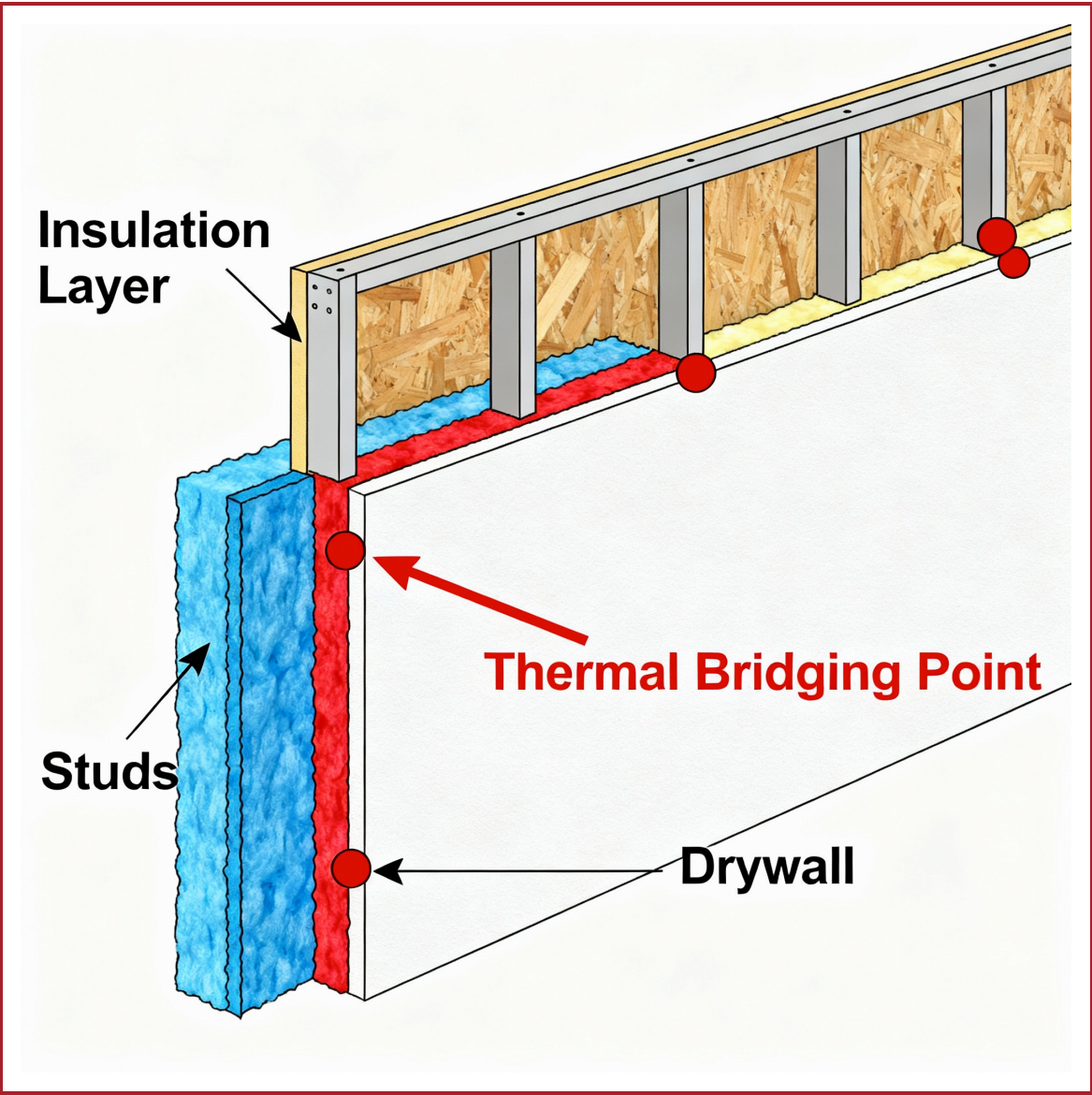

Figure: Wall assembly insulation detail showing thermal bridging points.

### **Pro Tip: Advanced Insulation Methods**

#### **What Pros Use:**

- *Spray Foam Insulation: Creates an airtight seal; ideal for rim joists and attics.*
- *Dense-Pack Cellulose: Excellent for walls; made from recycled materials.*
- *Rigid Foam Board: Exterior insulation to eliminate thermal bridging.*

### **R-Values for Maine:**

- Attic: R-60 minimum
- Walls: R-24–R-30
- Basement/Crawl Space: R-15–R-20

### **Window & Door Sealing**

- Use weatherstripping on all operable windows and doors.
- Install storm windows/doors for added protection.
- Seal penetrations (pipes, wires, vents) with spray foam or caulk.

### **Heating Systems for Maine**

#### **Oil/Propane Boilers:**

- Traditional choice; radiant floor heating provides even warmth.

#### **Heat Pumps:**

- Modern cold-climate heat pumps work efficiently down to -15°F.
- Ductless mini-splits ideal for additions and zone heating.

#### **Wood/Pellet Stoves:**

- Backup heat source; nostalgic and cost-effective.

***Pro Tip:** Professional builders often install hybrid systems—heat pumps for mild weather, boilers for deep winter.*

## **Renewable Energy**

- **Solar Panels:** Maine's net metering makes solar attractive; south-facing roofs ideal.
- **Battery Storage:** Backup power during outages.

**Call to Action: Want to maximize energy efficiency? Generations Custom Homes designs homes with advanced insulation and modern heating systems. [Learn more.](#)**

# 6. Interior Durability & Finish Work

Generational homes feature interiors built to last, with materials and craftsmanship that resist wear and maintain beauty.

## Flooring Choices

### Hardwood:

- Oak, maple, or hickory; timeless and durable.
- Avoid in high-moisture areas (bathrooms, mudrooms).

### Engineered Hardwood:

- More stable than solid wood; resists humidity changes.

### Tile/Stone:

- Ideal for bathrooms, kitchens, mudrooms.
- Heated floors add comfort in winter.

### Luxury Vinyl Plank (LVP):

- Waterproof, durable, affordable.
- Looks like hardwood but requires less maintenance.

**Pro Tip:** *Install radiant floor heating in bathrooms and mudrooms for comfort and to prevent moisture damage.*

## Cabinetry & Millwork

### Moisture-Resistant Materials:

- Marine-grade plywood for coastal homes.
- Solid wood with quality finishes for inland homes.

***Pro Tip:** Custom trim, wainscoting, and built-ins add character and value. Professional builders use tight joinery and premium fasteners.*

## Paint & Finishes

- Low-VOC paints for healthier indoor air.
- Semi-gloss or satin finishes in high-traffic areas for easy cleaning.

**Call to Action: Generations Custom Homes offers custom millwork and finish carpentry. Contact us for interior consultations.**

# 7. Seasonal Maintenance Schedules

Proper maintenance extends the life of your generational home and prevents costly repairs.

## Winter Prep Checklist (October–November)

- Clean gutters and downspouts
- Inspect roof for damaged shingles
- Seal cracks in foundation and siding
- Service heating system
- Insulate outdoor faucets; drain sprinkler systems
- Install storm windows/doors
- Stock firewood and check chimney

*Pro Tip: Keep roof rakes handy to remove heavy snow and prevent ice dams.*

## Spring Inspection (April–May)

- Check foundation for cracks or settling
- Inspect siding and trim for winter damage
- Clean windows and screens
- Test sump pumps and drainage systems
- Reseal deck and outdoor wood surfaces
- Prune trees away from roof and power lines

## Summer Exterior Care (June–August)

- Power wash siding (low pressure)
- Repaint/re stain as needed
- Inspect and repair window caulking
- Check HVAC systems
- Maintain landscaping and irrigation

## Fall Storm Readiness (September–October)

- Trim overhanging branches
- Secure outdoor furniture and equipment
- Inspect and repair roof flashing
- Test backup generators
- Review emergency plans and supplies

**Call to Action: Need help with seasonal maintenance? Generations Custom Homes offers maintenance services and consultations. Get in touch.**

## 8. Landscaping & Site Drainage

Proper grading and drainage protect your foundation and prevent water damage.

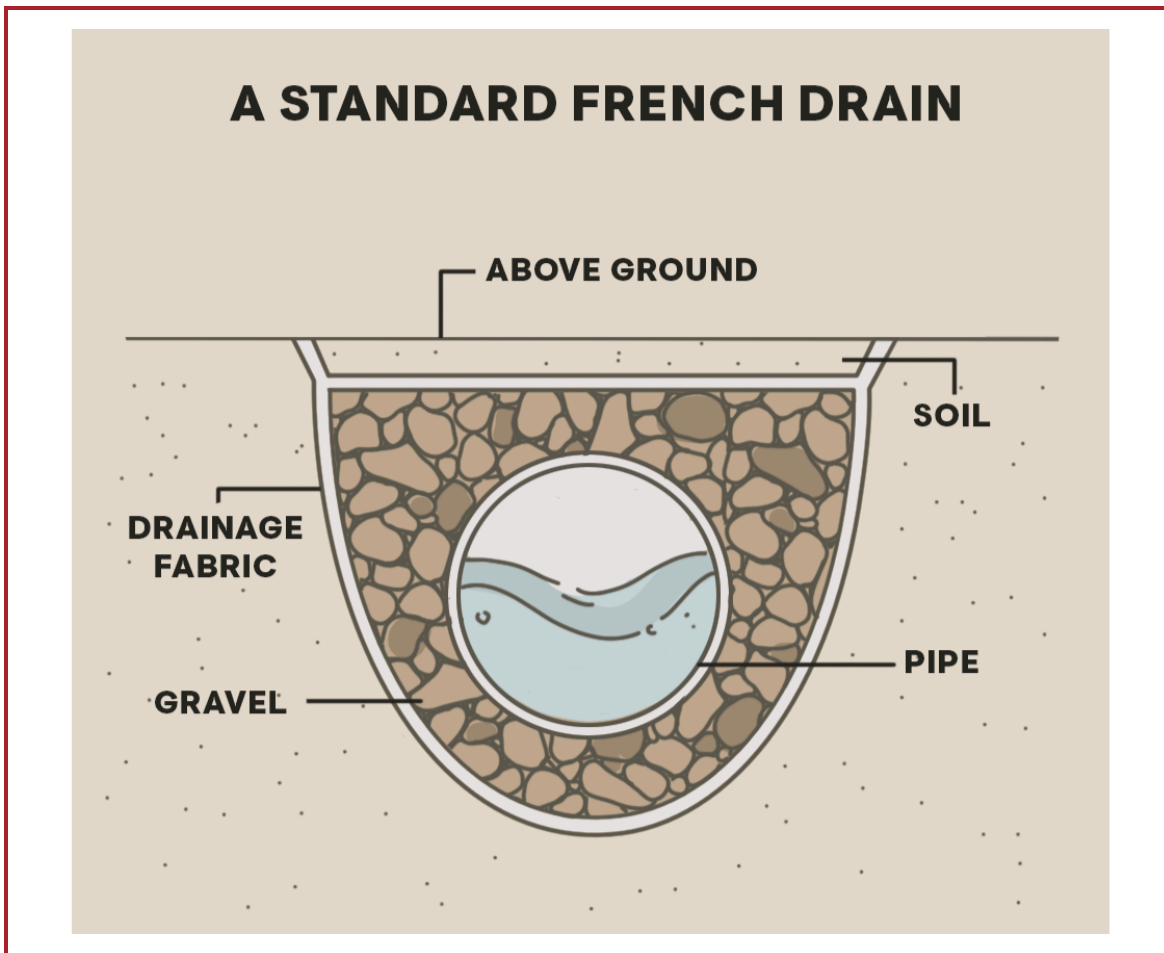

Figure: Perimeter French drain installation for foundation protection.

**Pro Tip: Grading & French Drains**

**What Pros Do:**

- *Grade soil away from foundation (minimum 6" drop over 10 feet).*
- *Install French drains around foundation perimeter.*
- *Use drain tile and gravel to channel water away.*

### **Coastal Homes:**

- Plant native, salt-tolerant vegetation.
- Use erosion control methods (riprap, retaining walls).

### **Inland Homes:**

- Avoid planting large trees near foundations.
- Use mulch and ground cover to prevent erosion.

### **Native Plant Recommendations**

#### **Coastal:**

- Beach plum, rugosa rose, bayberry, sea lavender

#### **Inland:**

- White pine, sugar maple, blueberries, ferns

***Pro Tip:*** *Native plants require less water and maintenance; they thrive in Maine's climate.*

# 9. Emergency Preparedness & Safety

Generational homes are designed to keep families safe during Maine's severe weather events.

## Backup Power

### Portable Generators:

- Affordable; powers essential circuits.

### Whole-House Generators:

- Automatic start; runs on propane or natural gas.
- Professional installation required.

### Battery Backup Systems:

- Silent, clean; integrates with solar panels.

**Pro Tip:** *Install a transfer switch for safe, code-compliant generator operation.*

## Storm-Proofing Coastal Homes

- Reinforce garage doors and windows.
- Install hurricane straps and tie-downs.
- Elevate utilities above flood levels.
- Keep emergency supplies (water, food, flashlights, batteries).

## Safety Systems

- Smoke and carbon monoxide detectors on every level.
- Fire extinguishers in kitchen, garage, workshop.
- Sump pump with battery backup.

**Call to Action: Generations Custom Homes integrates safety systems into every build. Discuss your safety needs with our team.**

# 10. Long-Term Value & Upgrades

Strategic upgrades and renovations protect your investment and enhance your home's generational appeal.

## High-ROI Upgrades

- **Kitchen Remodels:** Modern kitchens attract buyers and improve daily living.
- **Bathroom Upgrades:** Spa-like bathrooms add luxury and value.
- **Energy-Efficient Windows:** Lower utility bills and increase comfort.
- **Smart Home Technology:** Thermostats, security, lighting—modern convenience.

## Renovation Strategies

### When to DIY:

- Painting, landscaping, minor repairs

### When to Hire Pros:

- Structural changes, electrical, plumbing, roofing

***Pro Tip:** Always pull permits for major renovations to ensure code compliance and maintain resale value.*

## Future-Proofing

- Design flexible spaces (home offices, guest suites).
- Install wiring and infrastructure for future tech.
- Choose timeless finishes that won't date quickly.

**Call to Action:** Considering a renovation? Generations Custom Homes handles remodels and additions with the same generational quality as new builds. Start your project.

# 11. Working with Generations Custom Homes

At Generations Custom Homes, we're committed to building generational homes that reflect your vision and withstand Maine's toughest conditions.

## Our Process

1. **Initial Consultation:** Discuss your vision, budget, and timeline.
2. **Site Evaluation:** Assess your land and recommend design strategies.
3. **Custom Design:** Collaborate with architects and designers.
4. **Transparent Budgeting:** Detailed estimates with no hidden costs.
5. **Expert Construction:** Skilled craftsmen using proven techniques.
6. **Final Walkthrough:** Ensure every detail meets our standards—and yours.

## Why Choose Generations Custom Homes?

- **Decades of Experience:** Building in Maine since 2012.
- **Generational Philosophy:** Homes built to last for generations.
- **Local Expertise:** We understand coastal vs. inland challenges.
- **Transparent Communication:** You're involved every step of the way.
- **Quality Craftsmanship:** Every detail reflects our commitment to excellence.

**Call to Action:** Ready to build your Maine legacy? Contact Generations Custom Homes today for a free consultation. Visit us at [generationscustomhomes.com](https://www.generationscustomhomes.com) or call 207-460-2400.

# 12. Appendix & Resources

## Glossary of Terms

- **Frost Line:** Depth at which ground freezes in winter.
- **Ice Dam:** Buildup of ice on roof edge; causes leaks.
- **R-Value:** Measure of insulation effectiveness.
- **Flashing:** Waterproof barrier around roof penetrations.
- **Thermal Bridging:** Heat loss through framing members.

## Helpful Resources

- [Maine State Building Codes](#)
- [Energy Star](#)
- [FEMA Flood Maps](#)
- [Maine Geological Survey](#)

## Contact Generations Custom Homes

- **Phone:** 207-667-0038
- **Email:** [info@generationscustomhomes.com](mailto:info@generationscustomhomes.com)
- **Website:** [generationscustomhomes.com](http://generationscustomhomes.com)
- **Office Address:** 218 Downeast Hwy, Ellsworth, ME 04605

## Conclusion

Building or maintaining a generational home in Maine is a rewarding journey, one that combines thoughtful design, expert craftsmanship, and ongoing care. This guide provides the professional insights and pro tips you need to make informed decisions and protect your investment for decades to come.

At Generations Custom Homes, we're here to help you every step of the way. Whether you're planning a new build, considering a renovation, or simply need maintenance advice, our team is ready to assist.

**Download this guide, share it with your family, and start planning your Maine legacy today.**



Generations Custom Homes

218 Downeast Hwy, Ellsworth, ME 04605

[info@generationscustomhomes.com](mailto:info@generationscustomhomes.com) | 207-667-0038

[generationscustomhomes.com](http://generationscustomhomes.com)

[Facebook](#) | [Instagram](#)

---

© 2026 Generations Custom Homes. All Rights Reserved.

*This guide is for informational purposes only. Always consult with licensed professionals for specific advice related to your property.*